



Patent # US 7,100,956 BA  
Installation Instructions Ford F-150 thru F-350 and Ranger  
P/N's FD80002, FD80010



**CAUTION**

**IT IS NOT RECOMMENDED MOUNTING THE TIREGATE ON TRUCKS THAT HAVE REAR FIBER GLASS REPLACEMENT FENDERS. THE BED DOES NOT HAVE THE REQUIRED STRUCTURAL STRENGTH TO SUPPORT THE TIREGATE AND THE SPARE TIRE. ADDITIONAL BRACING WILL BE REQUIRED.**

1. Remove tailgate by disconnecting the tether cable and lifting the tailgate out at approximately a 45° angle. Reference the truck's Owner's manual.
2. Carefully remove the OEM tailgate pivot cups from the tailgate taking note of which side they belong on.

**NOTE**

On F-150 (FD80002) make sure the OEM left side pivot cup remains on the truck. The OEM right pivot cup is replaced by both the PC002 and the PC004 pivot cups .

Please call us at (877) 945-2684 if you have any questions or comments.

3. Remove tether bolt. A special wrench may be required.
4. Remove latch pin bolt. A special wrench may be required.
5. Figure 1 through 5 shows the three style of TireGates.
6. Slide the torque tube onto the left and right upright mounts. See Figure 1.
7. Install supplied pivot cups and the right and left OEM pivot cups in left and right side uprights. See Figure 5.
8. Install new left side pivot cup in left side upright on the '04-'07 F150 only. Other model years will re-use the stock pivot cup. See Figure 1.
9. With the left and right uprights pushed in on the torque tube, install onto the pivot pin location and install the torque tube bolts and washer, 4 places (M10X70M , washers and lock nuts) to keep the uprights from turning. **DO NOT** tighten lock nuts yet.
10. Due to truck manufacturing tolerances, it may be necessary to loosen the bolts attaching the truck's tail gate pivot pin(s) to properly locate the TireGate's left and right uprights. See Figure 6.
11. Install uprights with M10x100 (M8X90 for FD80010) bolts, washer and support washer (4 large washers get installed between the upright and the truck) upper locations. Install 2xM10x100 (M8X90 for FD80010) bolts and washers in the lower position. See Figure 1.

#### NOTE

To mount the TireGate in the inboard direction, install the latch pin cable bracket on the left side lower bolt. For the outboard direction, install on the right side location. See Figure 6.

12. Tighten the four (4) upright bolts. M10 torque to 35-38 ft/lbs.
13. If necessary, tighten the bolts securing the truck's tail gate pivot pin(s) to factory specs.
14. Tighten the four (4) torque tube bolts. M10X70M torque to 30-35 ft/lbs.
15. Install bushings on the TireGate. The slotted bushing will be installed on the latch pin side and positioned so the slot is across the truck. The pivot bushing will be installed on the hinge side of the TireGate. See Figure 1.
16. Lift the TireGate and install both latch pins to hold gate in position.
17. To install black plastic trust washers, hold them on the top and the bottom of the gate as you slide the gate into the upper and lower clevises. Insert M10X100 hex bolts (Note: Grease the shaft of the bolt before installation. Do not grease the trust washers) Tighten just enough to take the slack out of the bolts and then torque to 18-22 ft/lbs. **DO NOT** over tighten the lock nuts.
18. Install spare tire using the Y bar and safety cable as shown in Figure 7.

#### NOTE

The VT Series TireGate can be mounted in the OUTBOARD configuration ONLY and does not utilize the TireGate Y bar to secure the spare tire. Spare tire must be mounted using the supplied lug nuts and studs.

Please call us at (877) 945-2684 if you have any questions or comments.

**WARNING**

**MAXIMUM SPARE TIRE WEIGHT ON THE TIREGATE MUST NOT EXCEED 150 LBS.**

19. Latch safety cable to the Y bar handle and the TireGate using the supplied safety shackle as shown in Figure 7. A pad lock (customer supplied) may be added with the supplied safety shackle for added security.

**WARNING**

**DO NOT USE THE TIREGATE WITHOUT THE SAFETY CABLE SECURELY ATTACHED TO THE Y BAR HANDLE AND THE TIREGATE.**

20. Tighten the Y bar until the tire is drawn securely to the TireGate.  
21. Make sure all bolts are tight before operating the vehicle.  
22. Recheck all fasteners after 4-8 hours of use (1 hour if off-road). Check TireGate as a normal part of your truck maintenance.

Please note that all TireGate series mount to the truck in the same manner.  
All will use the same installation instructions.



**NOTE:**

The VT Series TireGate can be mounted in the OUTBOARD configuration ONLY.



(Not available for Ranger)

Please call us at (877) 945-2684 if you have any questions or comments.

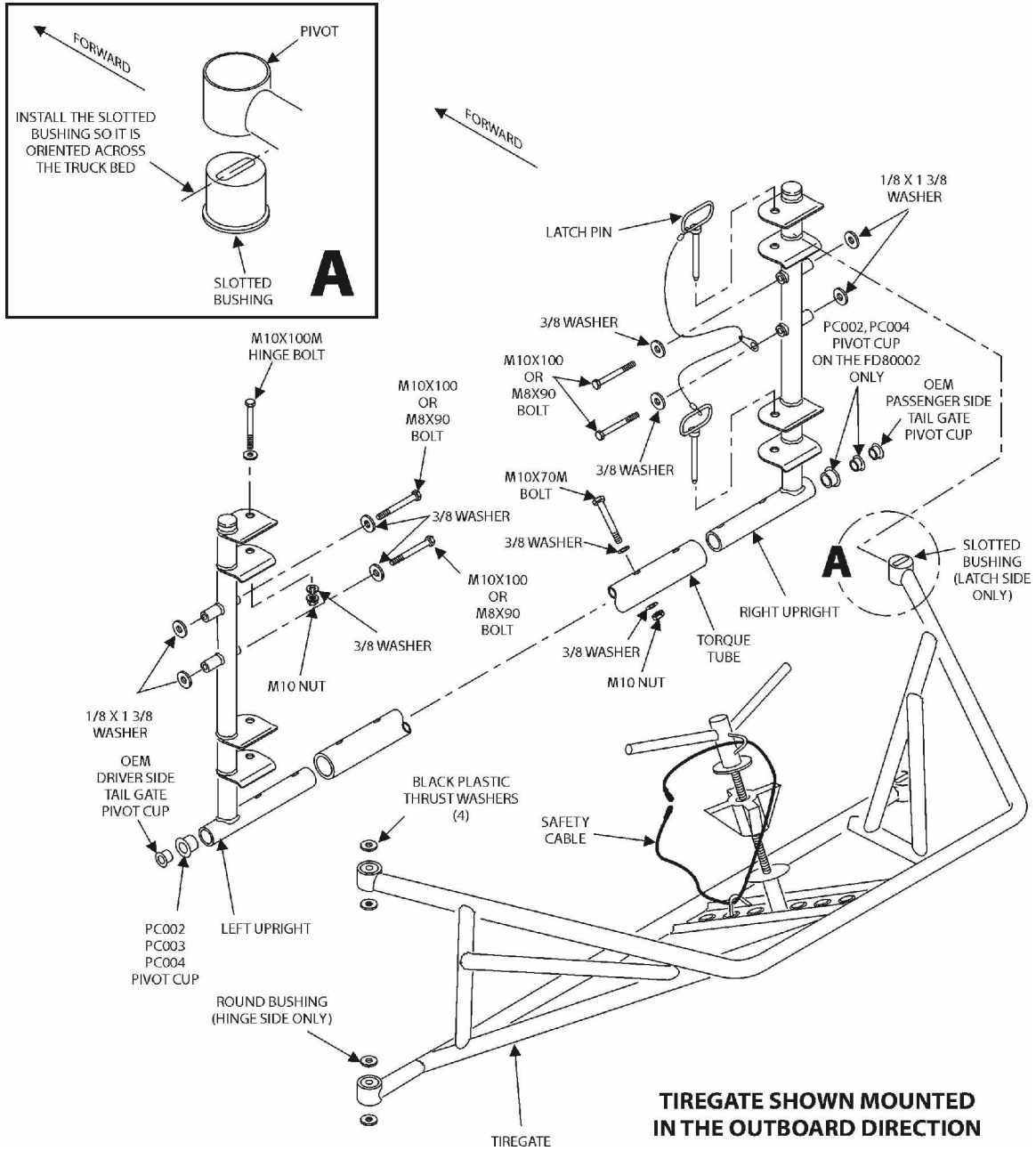

**Figure 1. TireGate mounted in the outboard direction.**

Please call us at (877) 945-2684 if you have any questions or comments.

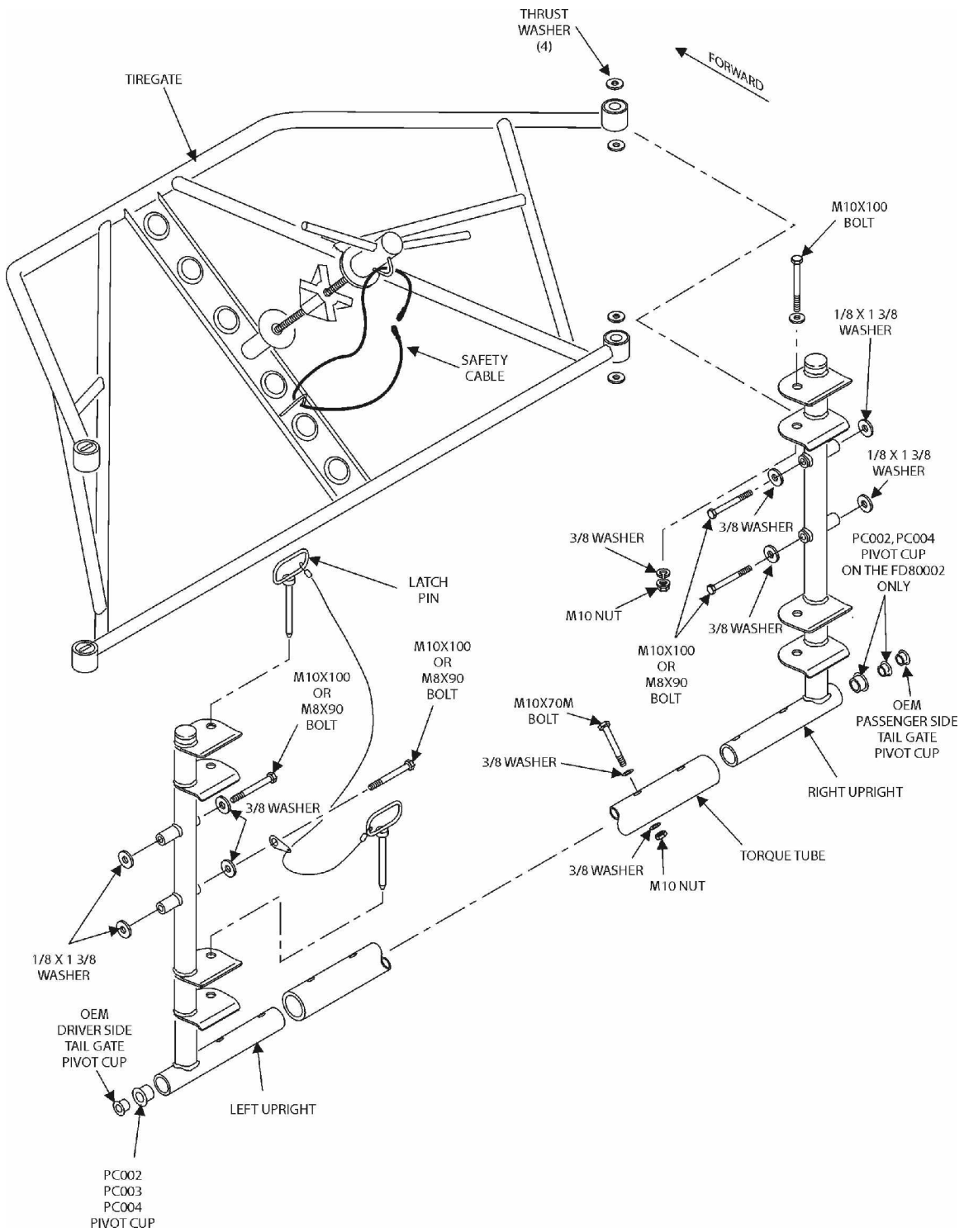

**Figure 2. TireGate mounted in the inboard direction.**

Please call us at (877) 945-2684 if you have any questions or comments.

**TIREGATE VT MOUNTS IN THE OUTBOARD DIRECTION ONLY AND DOES NOT UTILIZE THE TIREGATE Y BAR TO SECURE THE SPARE TIRE.**

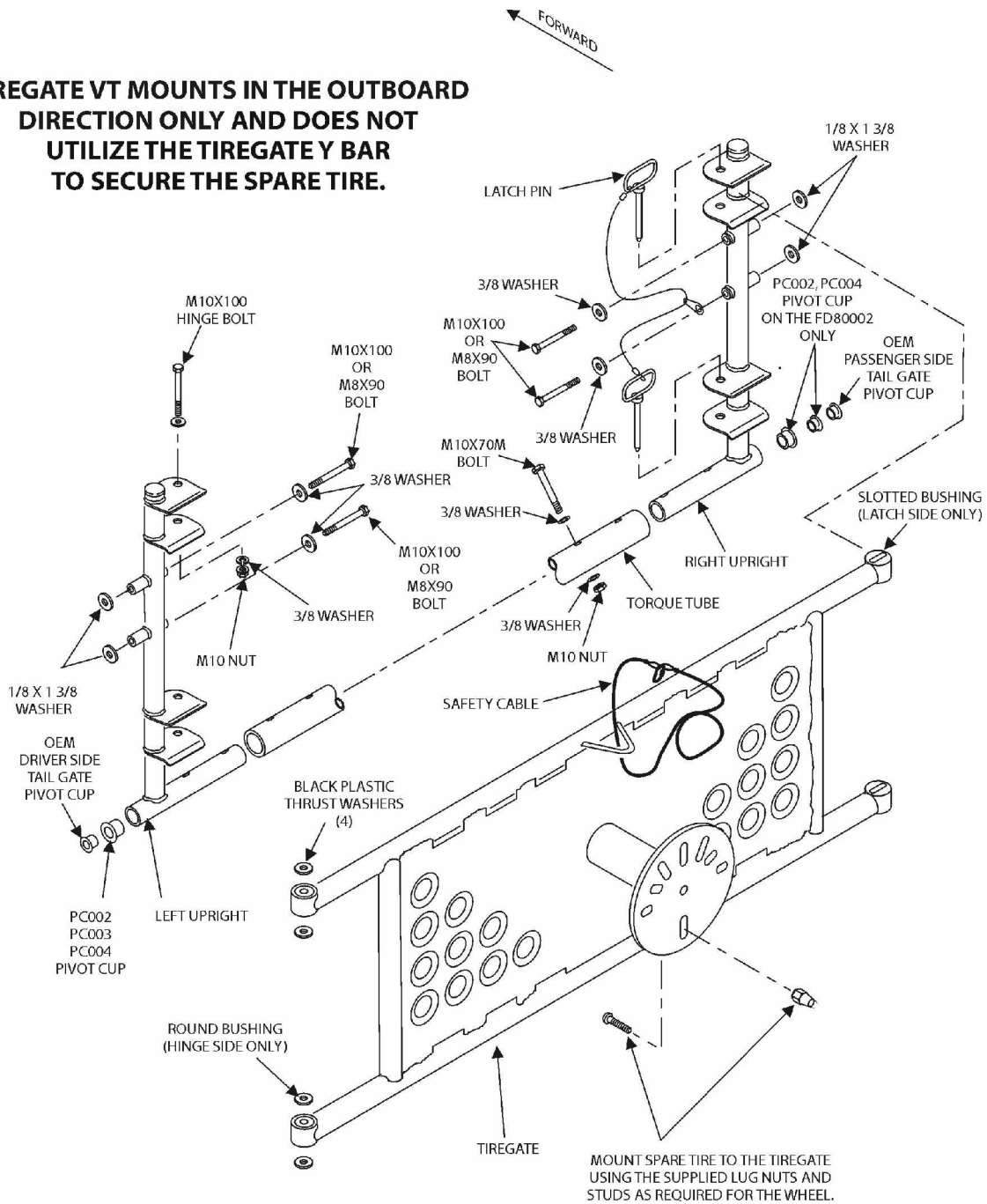

**Figure 3. TireGate VT mounted in the outboard direction.**

Please call us at (877) 945-2684 if you have any questions or comments.

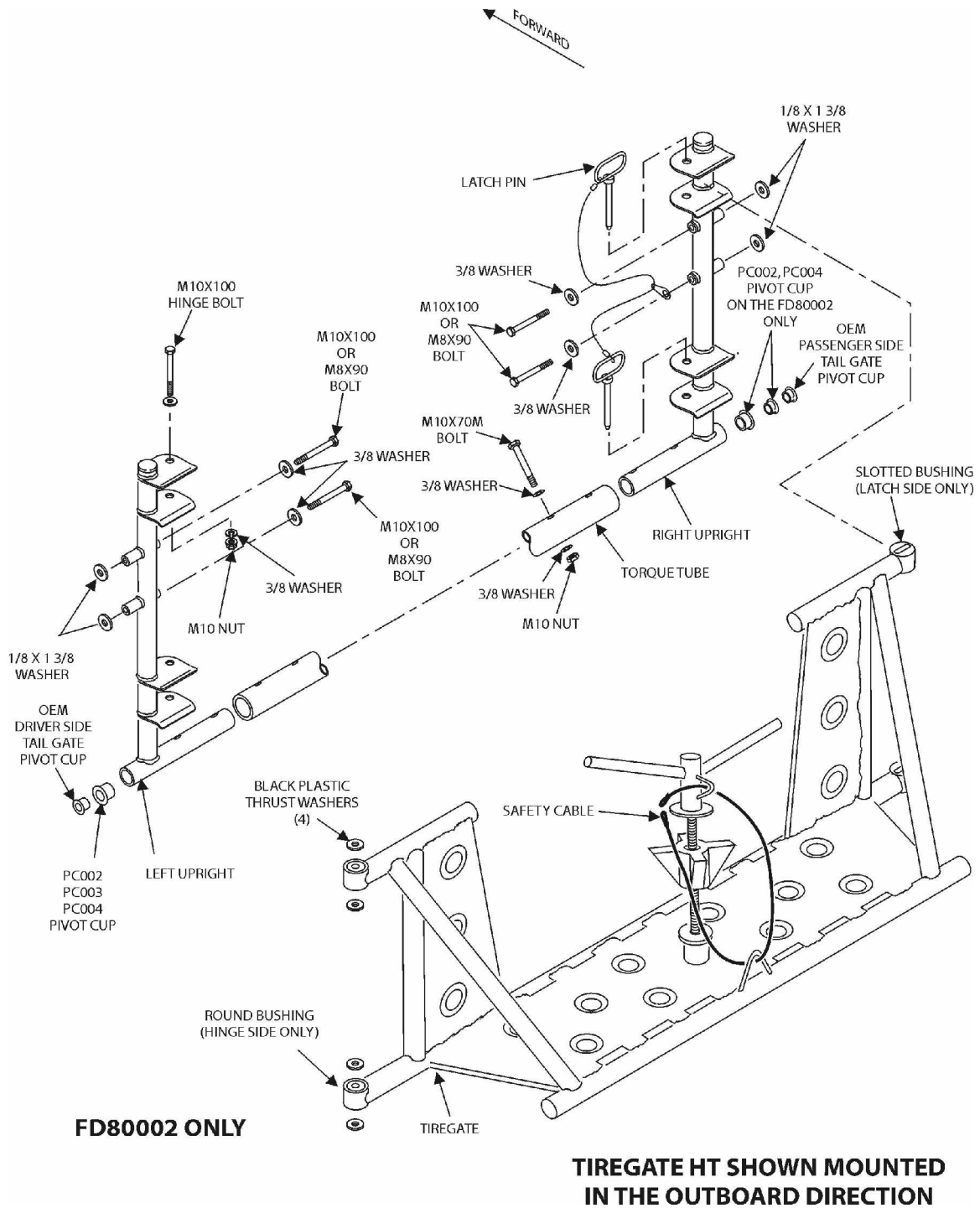

**Figure 4. TireGate HT mounted in the outboard direction.**

Please call us at (877) 945-2684 if you have any questions or comments.

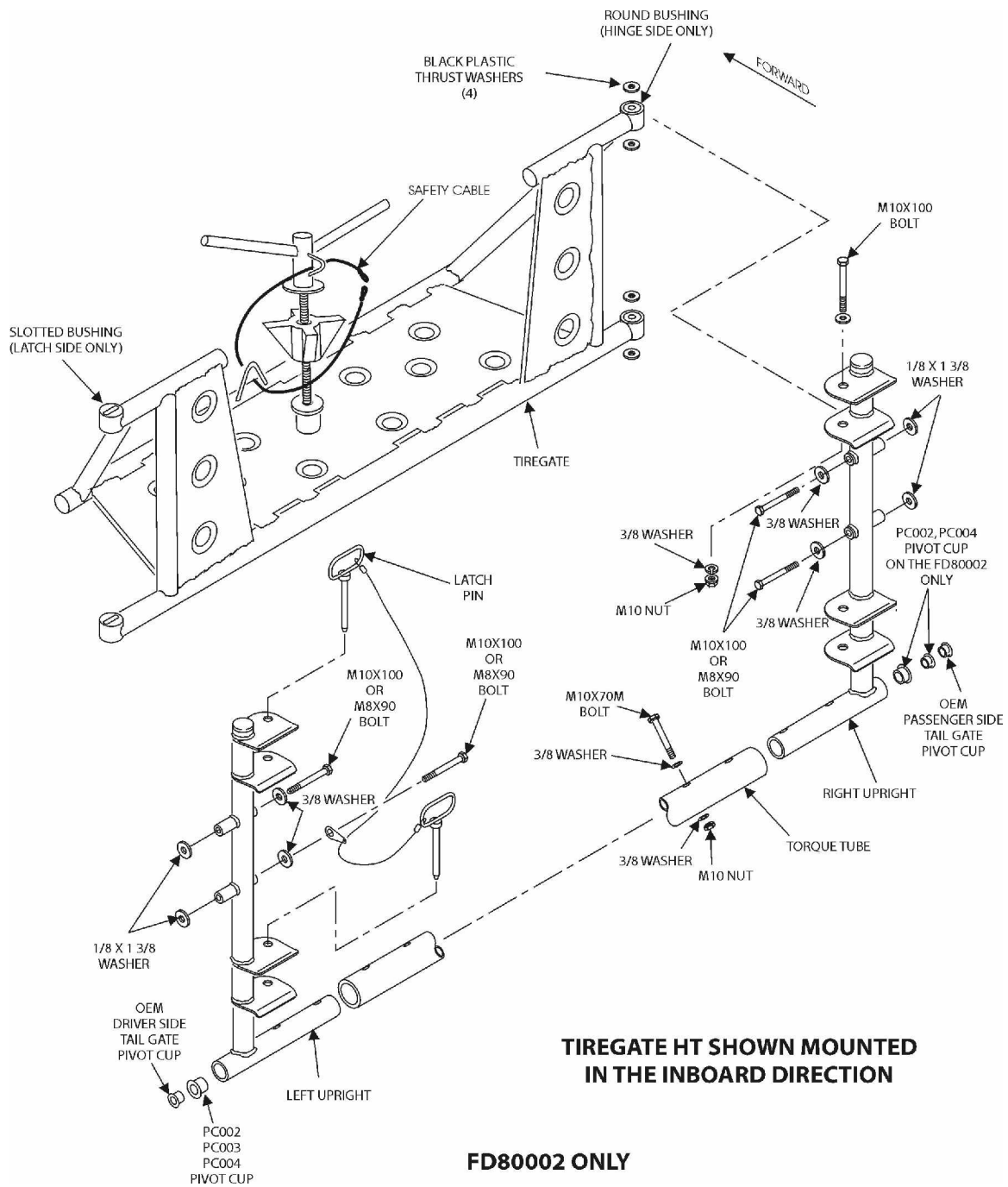

**Figure 5. TireGate HT mounted in the inboard direction.**

Please call us at (877) 945-2684 if you have any questions or comments.

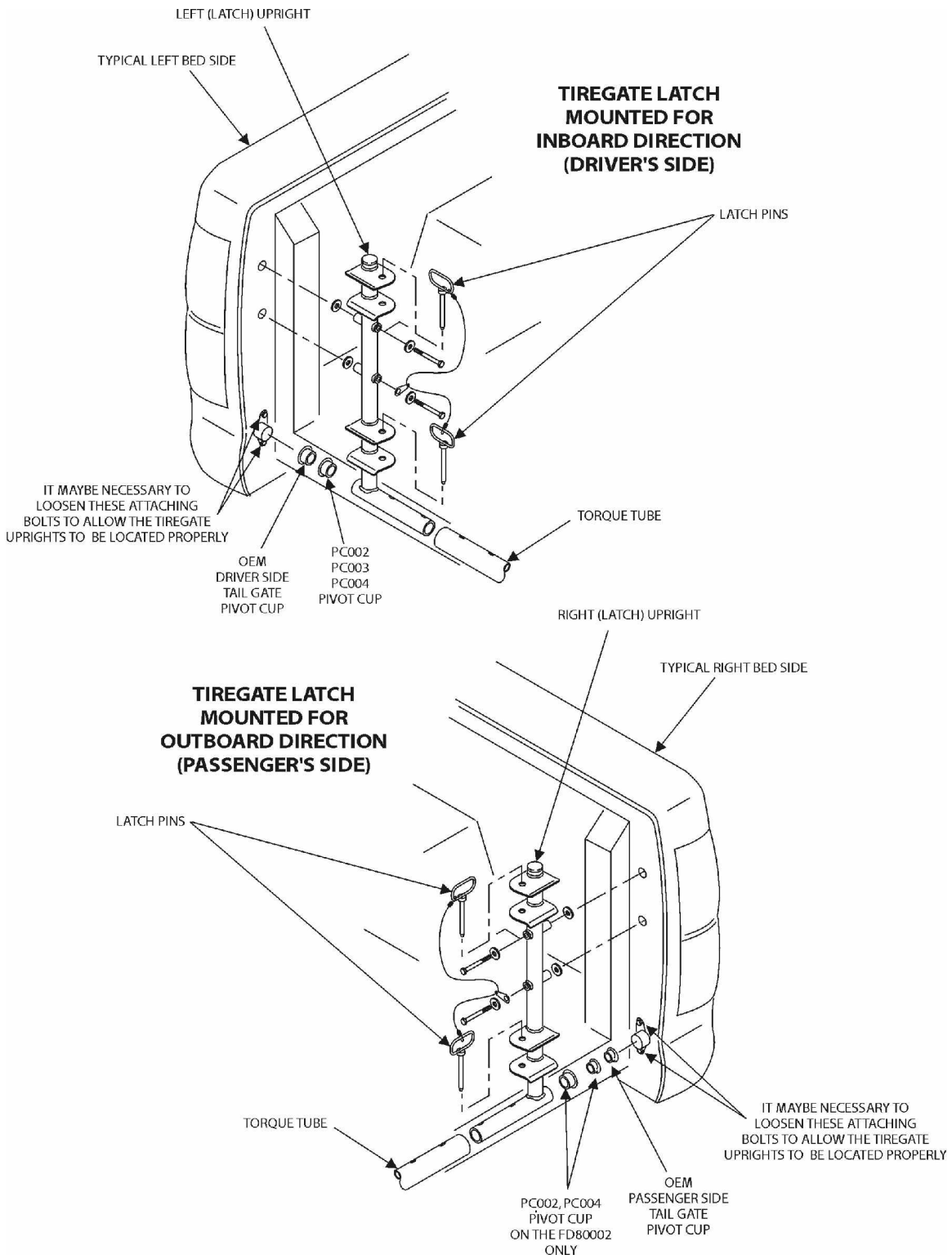

**Figure 6. Pivot Cups.**

Please call us at (877) 945-2684 if you have any questions or comments.

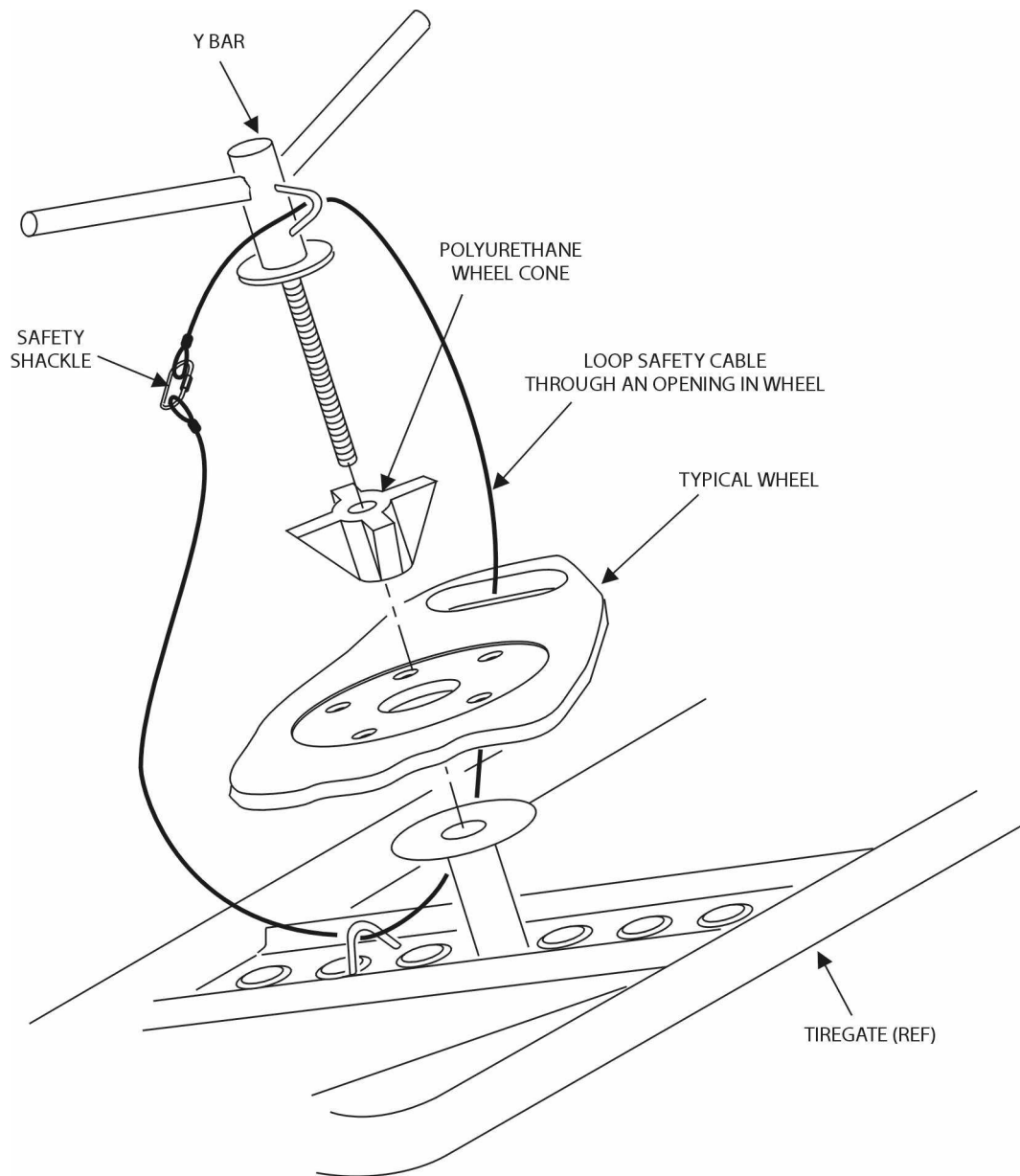

**WARNING**

**MAXIMUM SPARE TIRE WEIGHT ON  
THE TIREGATE MUST NOT EXCEED 150 LBS.**

**Figure 7. Typical spare tire mounting for all TireGate racks except the VT model.**